

# Ke-P1-06a - Workshop

This [Collapsible Rapid Deployment Module](#) has all the [standard features](#), and is divided into two sections. It became available in [YE 31](#).

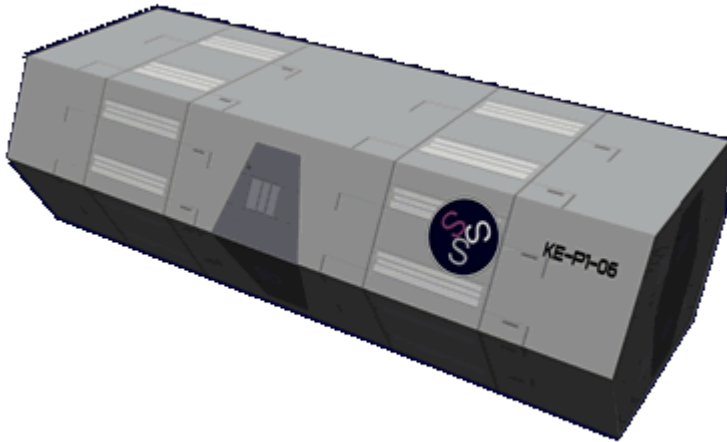

## Details

- Organization Using This item: [Scientific Studies Service \(SSS\)](#)
- Type: Portable structure
- Nomenclature: Ke-P1-06
- Designers: [Ketsurui Zaibatsu](#) Research and Development teams, [Scientific Studies Service \(SSS\)](#)
- Manufacturers: [Ketsurui Fleet Yards](#)
- Entered service: [YE 31](#)

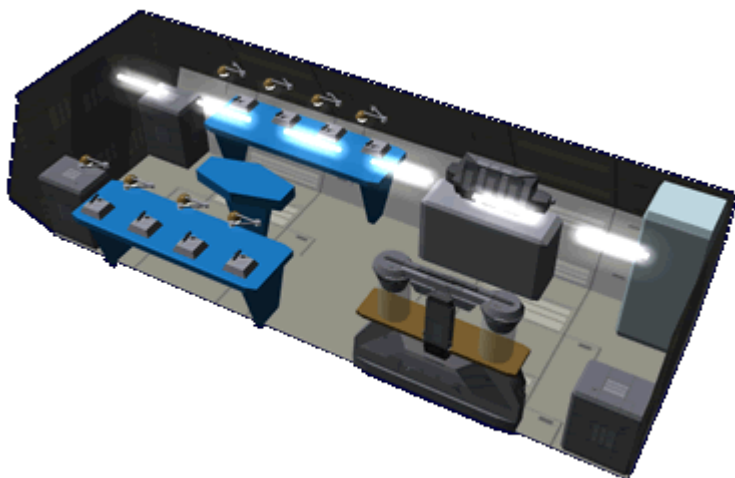

## Workshop

The left side of the module is the workshop. It contains the items needed to repair and maintain most common equipment. There are two benches with diagnostic equipment, and work table in the center. There are common parts stored in the bottom of the benches.

## Fabrication

The right side of the module is the fabrication area. This area contains a compact nodal system (located in the unit in the front) that converts raw material such as expedition refuse, into usable material. This is frequently used to make packaging to preserve and protect artifacts. It can also be used to make replacement parts for the workshop, by recycling broken components. The other equipment is for cutting and shaping material.

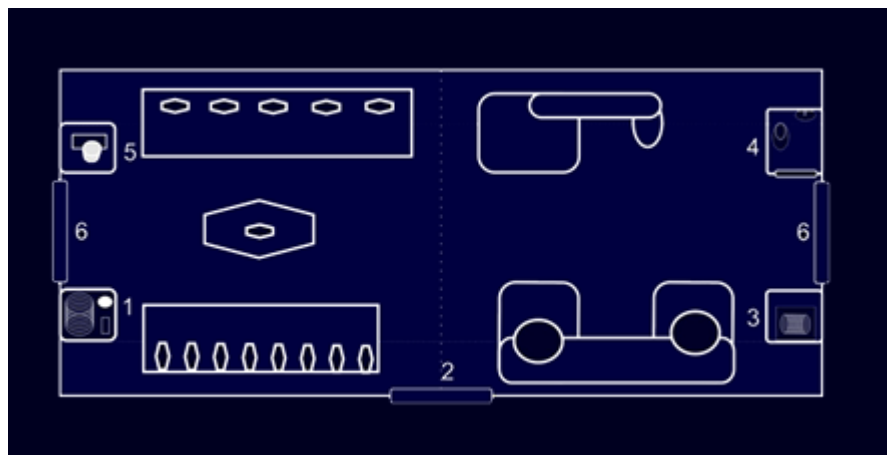

From:

<https://wiki.stararmy.com/> - **STAR ARMY**

Permanent link:

[https://wiki.stararmy.com/doku.php?id=stararmy:buildings:crdm:ke-p1\\_6a\\_workshop](https://wiki.stararmy.com/doku.php?id=stararmy:buildings:crdm:ke-p1_6a_workshop)

Last update: **2023/12/21 04:26**

